

88 Reference $\frac{1}{16}$ cor. SW Cor of the NW $\frac{1}{4}$ of the NE $\frac{1}{4}$ Sec 27. T. 11 N. R. 10 W. ^{CN}
 36" Hem Old Bearing Tree North 11.5'
 20 " " " 1788° E 21.0'

In the presents of N.E. Anderson Jan. 1923
 A.H. Gulstrom
 W.H. Stark

89 $\frac{1}{16}$ Cor. SW Cor of the NE $\frac{1}{4}$ of the NE $\frac{1}{4}$ of Sec 27. T. 11 N. R. 10 W. ^{NE $\frac{1}{16}$}
 50" fir 1775° N 34.3'
 30" Spruce Old B.T. 361° E 101.0'

In the presents of N.E. Anderson
 Jan. 1923 A.H. Gulstrom
 W.H. Stark

90 $\frac{1}{16}$ Cor. S.E. Cor of the NE $\frac{1}{4}$ of the NE $\frac{1}{4}$ of Sec 27. T. 11 N. R. 10 W. ^{N $\frac{1}{16}$ E body}
 12" Spruce tree bears 132° 45' W 38.83
 16 " " " 1123° 30' E 32.9'

In the presents of N.E. Anderson
 Jan 1923 A.H. Gulstrom
 W.H. Stark

91 $\frac{1}{16}$ Cor. SW Cor of the SW $\frac{1}{4}$ of the SW $\frac{1}{4}$ of Sec. 28. T. 15. R. 10 W. ^{S $\frac{1}{16}$ W body}
 12" Spruce bears west 178° 18'
 8" Spruce " South set 5'

In the presents of Donis
 N.E. Anderson
 C. Stranahan
 June 14 - 1923

Center $\frac{1}{16}$ cor found old B.T. Down so set new stake
 between Sec 6 and 7 from which 12" Hem bears S 85° W 24.2'
 T. 3. S. R. 9 W 14" Hem N 50° W 50.0' (505)

A.H. Gulstrom
 Ben Wiggins Apr. 1948

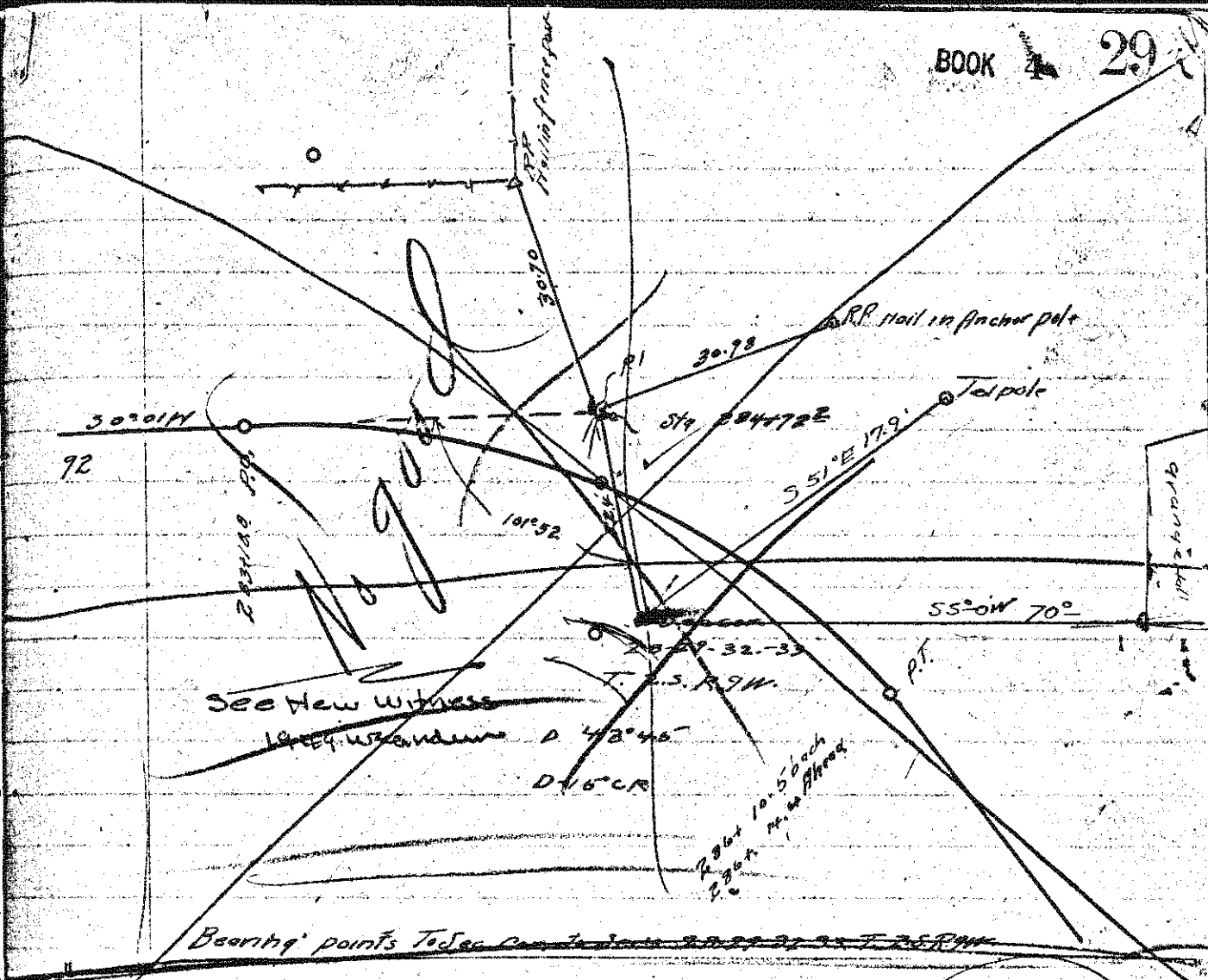

$\frac{1}{4}$ Cor. between Sec 29. 32. T. 15. R. 9 W. ^{Established}
 Re Set Cor. and one bearing tree
 24" hem. Bears N 86° W 5.8
 22" " " N 10° W 25.6

In the presents of C. Diamond
 N.E. Anderson July 5 - 1923.
 A.H. Gulstrom

See note
 book
 p. 9 p. 6

S.E. Cor of the NW $\frac{1}{4}$ of the NW $\frac{1}{4}$ Sec 30. T. 15. R. 9 W. N. 1 A.
 94 Set $\frac{1}{16}$ cor. Spruce limb from which a 14" leaning
 Alder bears south 9.8' a 6" Alder bears S 24° 16' E 57.34

In the presents N.E. Anderson
 A.H. Gulstrom Aug 7 - 1923.
 C. Stranahan

in center
 Sec 6. T. 35 R set 1. Pipe near edge of pavement
 from which a 10" ~~bears~~ N 12° 5' W 19.5' a 6" Hem N 12° 5' W 19.5'
 8" fir ~~bears~~ S 32° 30' E 20.4 6" Spr 119° 5' W 31'
 1948 Russel Forest
 A.H. Gulstrom - Ben Wiggins